



- Interface to RS-232 and RS-485 controllers
- Interface to USB controllers
- Three addressing modes
- Zigbee network management
- Hundreds of devices in a single network
- Optional Internet via Cell, WiFi, Ethernet

**Build your own network:  
Remotely Monitor and Control your field equipment**

The AG101/AG102 AirGate modules are members of the AZN\* product family that provide the gateway between remote devices equipped with AirPoints and a host controller. The AG101 provides both RS-232 and RS-485 host interfaces. The AG102 is a USB host interface powered from the USB source.

The AirGate connected host sends data to and receives reports and alarms from every AirPoint on the network. Configured as Zigbee coordinator the AirGate provides network management for simple and flexible integration into your host application.

AirGate connects to most host configurations whether they be a dedicated control panel connected via RS-232, a local PC connected via USB, or an Internet based control application connect via cellular, WiFi, or Ethernet options. For 24x7 managed Internet service, Air2Apps' AirServ monitors AZN connected equipment, sending alerts to any number of users of event conditions via E-mail, Text messaging, Fax or Voice.

\* AZN is Air2Apps' implementation of the ZigBee™ wireless mesh network. AZN is a flexible, simple to install, expandable, network connecting hundreds of devices spread over large areas. See AZN product sheet.

## General Specifications

Operating Temperature:	-40°C to +85°C	
Supply Voltage:	AG101	9 to 36 VDC
	AG102	USB powered
Operating Current:	Sleep – <3 µA@3.3V typical Receive – 30 mA@3.3V typical Transmit – 25 mA@3.3V typical	
Size:	3.875" x 2.400"	

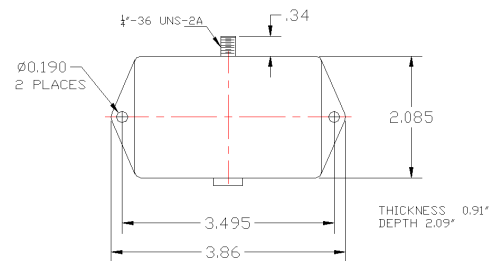

## Standard I/O

AG101	RS-232; TX/RX, 8,n,1 Baud rate: 1,200 to 115,000
	RS-485; Half duplex, 8,n,1 Baud rate: 1,200 to 115,000
AG102	USB 2.0

## Required Accessories

- Antenna